



# MDG/MDY70A

## Non-Insulated Type Diode Module

### Features

Non-insulated type, Baseboard servers as the public electrode  
 Full crimping structure, super temperature characteristics and power cycle capability  
 Lower forward voltage drop

$I_{F(AV)}$	70A
$V_{DRM}/V_{RRM}$	400-2600 V
$I_{FSM}$	2.5KA
$I^2T$	31.8 KA <sup>2</sup> S

### Application

AC/DC Motor Control  
 Various rectifying power suppliers  
 Industry Heating Regulation  
 Light Dimming  
 Contactless Switches  
 Motor Soft Start  
 Static Var Compensation/SVR  
 Welding Device  
 Converter  
 UPS Power Supplies  
 Battery Charge and Discharge

Symb.	parameter	Test Conditions	$T_{J(c)}$	Value	Unit
<b>Current Ratings</b>	$I_{F(AV)}$	average on-state current	180 °half sine wave 50Hz Single side cooled $T_c=115\text{ °C}$	70	A
	$I_{F(RMS)}$	RMS on-state current		94	A
	$I_{FSM}$	Surge on-state current	10ms half sine wave $V_R=0.6V_{RRM}$	2.50	KA
	$I^2t$	I <sup>2</sup> T for fusing coordination		31.8	KA <sup>2</sup> S
<b>Characteristics</b>	$V_{RRM}$	Repetitive peak reverse voltage	$V_{RRM}$ tp=10ms $V_{RSM}=V_{RRM}+200V$	400-2600	V
	$I_{RRM}$	Repetitive peak reverse current	at $V_{RRM}$	Max.6	mA
	$V_{FO}$	Threshold voltage		Max.0.80	V
	$V_{FM}$	Peak on-state voltage	$I_{FM}=180A$	Max.1.30	V
	$r_F$	On-state slop resistance		150	Max.2.39

## Thermal & Mechanical Data

Symb.	parameter	Test Conditions	Value	Unit
$R_{th(j-c)}$	Thermal resistance Junction to case	single side cooled	Max.0.500	°C/W
$R_{th(c-h)}$	Thermal resistance case to heat sink	single side cooled, 180 °half sine wave	Min.0.1	°C/W
$F_m$	Thermal connection torque(M5)		Typ.4.0	N m
	Mounting force (M6)		Typ.6.0	N m
$T_{stg}$	Stored temperature		-40+125	°C
$W_t$	Weight		220	g

### Outline:

M2

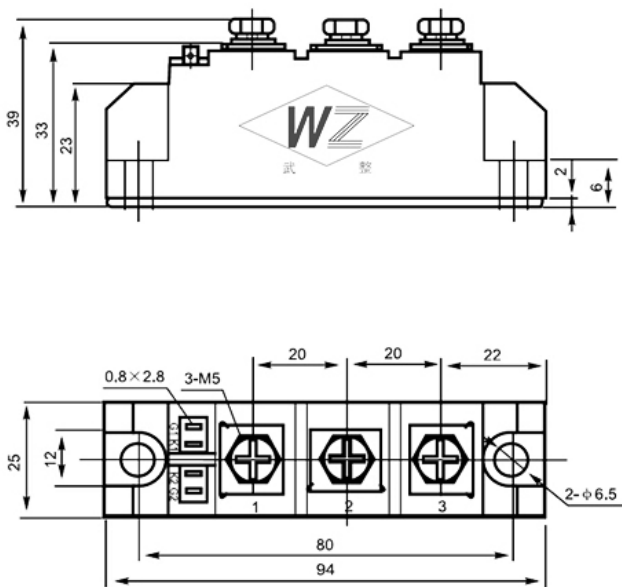

M36

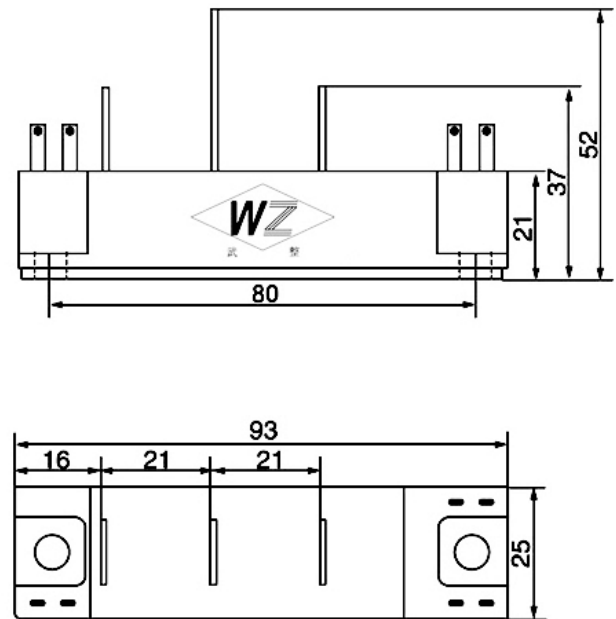

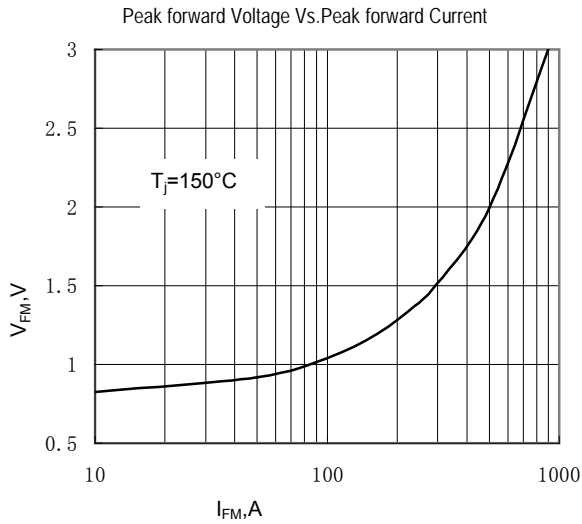

Fig.1

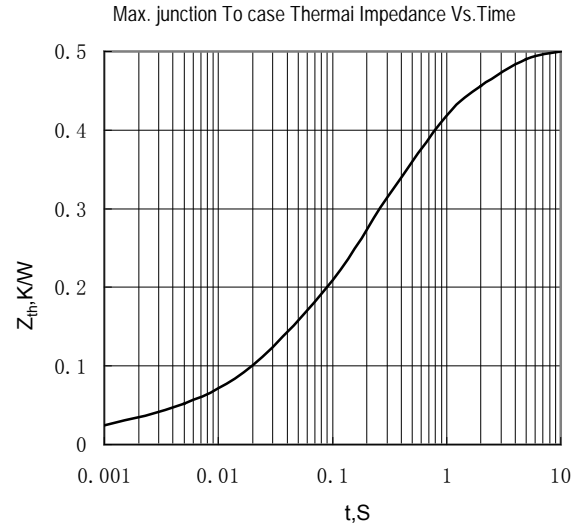

Fig.2

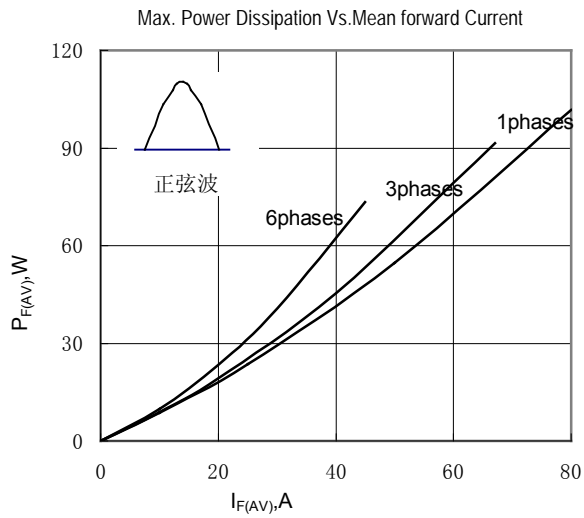

Fig.3

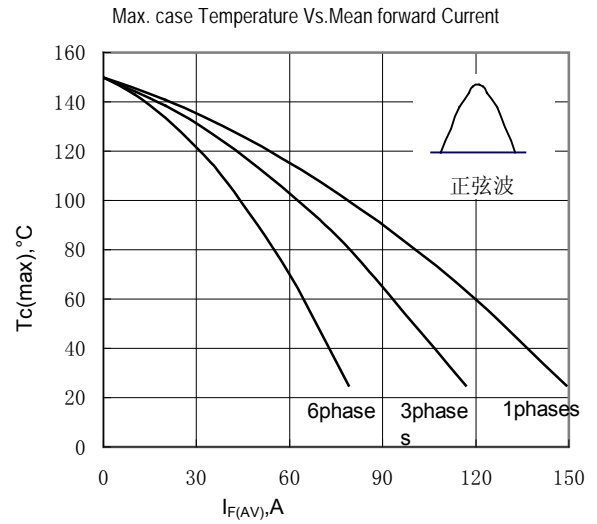

Fig.4

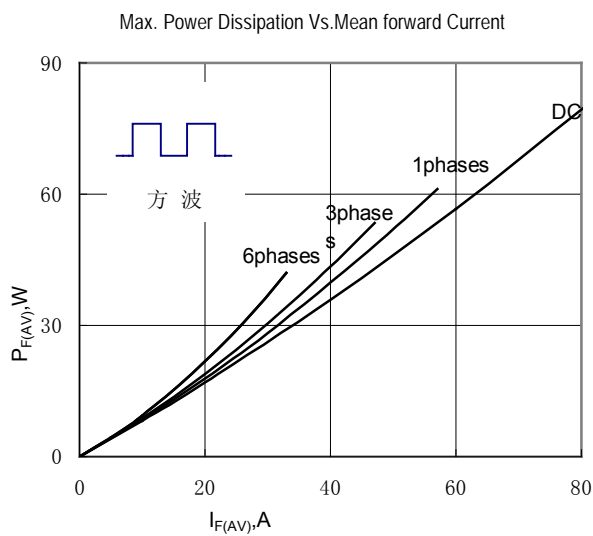

Fig.5

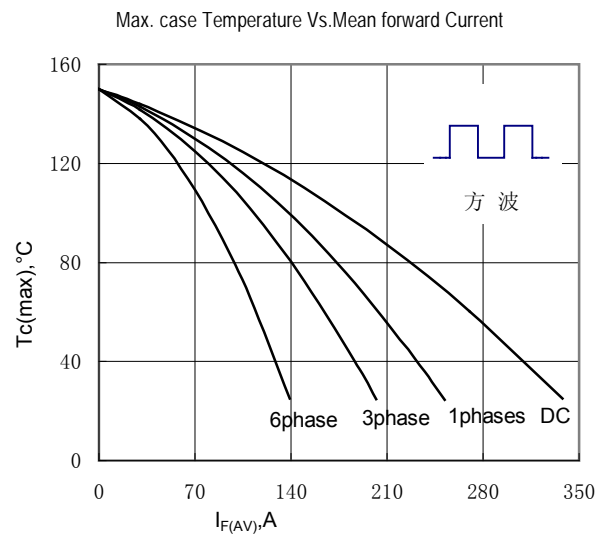

Fig.6

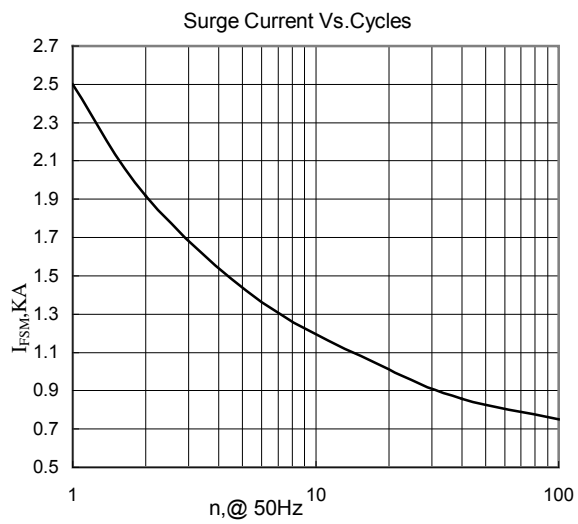

Fig.7

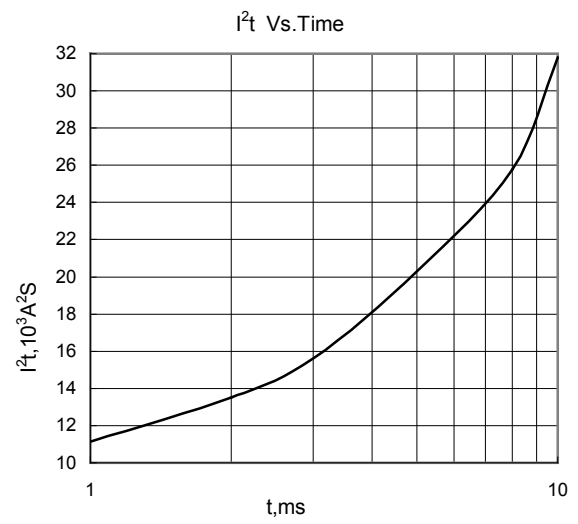

Fig.8

---

## Wuhan Wuzheng Rectifier Co., Ltd

**Add:** NO. 73 Gaoxin Five Road, East Lake New Technology Development Zone, Wuhan City, Hubei province.

**Tel :** 86-27-87001995

**Fax:** 86-27-87180920

**Email:** info@techele.com

**Web:** www.techele.com/en

cn-techele.en.alibaba.com