

KK400A-E



FAST TURN-OFF THYRISTOR

Features

- Interdigitated amplifying gate
- Fast switch and high di/dt
- Low switching loss

Application

- Converter
- Chopper
- Induction heating

$I_{T(AV)}$	400 A
V_{DRM}/V_{RRM}	800~1600V
t_q	16~35 μ s
I_{TSM}	5 KA
I^2T	125KA ² S

Symb.		parameter	Test Conditions	$T_{J(c)}$)	Value	Unit
Current Ratings	$I_{T(AV)}$	average on-state current	180° half sine wave 50Hz Double side cooled $T_{hs}=87^\circ C$	115	400	A
	I_{TSM}	Surge on-state current	10ms half sine wave $V_R=0.6V_{RRM}$	115	5	KA
	I^2t	I^2t for fusing coordination		115	125	KA ² S
Characteristics	V_{DRM} V_{RRM}	Repetitive peak off-state voltage Repetitive peak reverse voltage	$V_{DRM}\&V_{RRM}$ $t_p=10ms$ $V_{DSM}\&V_{RSM}=V_{DRM}\&V_{RRM}+100V$	115	800-1600	V
	I_{DRM} I_{RRM}	Repetitive peak current	$V_{DM}=V_{DRM}$ $V_{RM}=V_{RRM}$	115	Max.40	mA
	V_{TO}	Threshold voltage		115	Max.1.32	V
	V_{TM}	Peak on-state voltage	$I_{TM}=1200A, F=15KN$	25	Max.3.0	V
	r_T	On-state slop resistance		115	0.66	m Ω
	I_H	Holding current	$V_A=12V, I_A=1A$	25	20-400	ma
Dynamic Parameters	dv/dt	Critical rate of rise of off-state voltage	$V_{DM}=67\%V_{DRM}$	115	Max.500	V/ μ s
	di/dt	Critical rate of rise of on-state current	$V_{DM}=67\%V_{DRM}$ to 800A, Gate pulse $t_r \leq 0.5\mu s, I_{GM}=1.5A$	115	Max.300	A/ μ s
	t_q	Circuit commutated turn-off time	$I_{TM}=600A, t_p=1000\mu s, di/dt=-20A/\mu s, V_R=50V$	115	16-35	mA
	I_{rm}	Reserse recovery current	$I_{TM}=600A, t_p=1000\mu s, di/dt=-20A/\mu s, V_R=50V$	115	Max.68	A
	t_{rr}	Reverse recovery time		115	Max.4.1	μ s
Q_{rr}	Recovery charge	115		Max.139	μ c	
Gate Parameters	I_{GT}	Gate trigger current	$V_A=12V, I_A=1A$	25	40-250	mA
	V_{GT}	Gate trigger voltage		25	0.9-2.5	V
	V_{GD}	Non-trigger gate voltage	$V_{DM}=67\%V_{DRM}$	115	Min.0.3	V

Thermal & Mechanical Data

Symb.	parameter	Test Conditions	$T_J(^{\circ}C)$	Value	Unit
$R_{th(j-h)}$	Thermal resistance Junction to heatsink	Double side cooled, clamping force 15N		0.035	$^{\circ}C/W$
F_m	Mounting force			10-20	KN
T_{stg}	Stored temperature			-40-+140	$^{\circ}C$
W_t	Weight			270	g

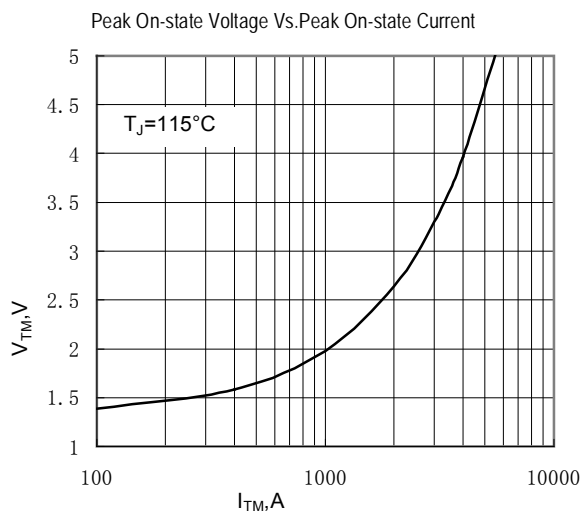

Fig.1

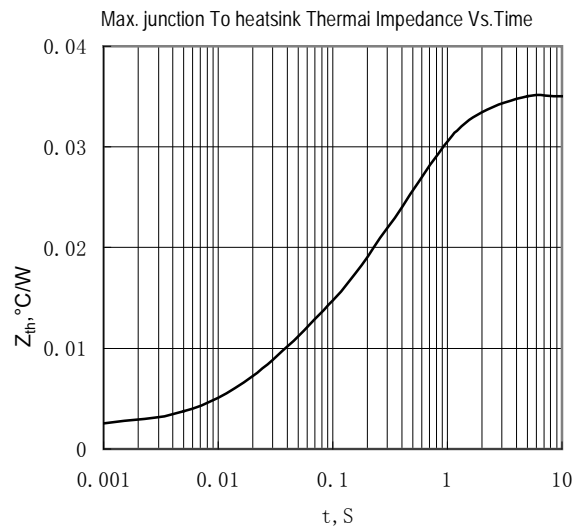

Fig.2

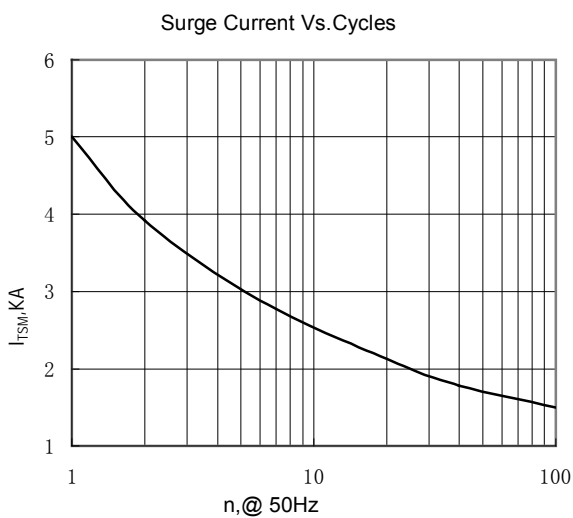

Fig.3

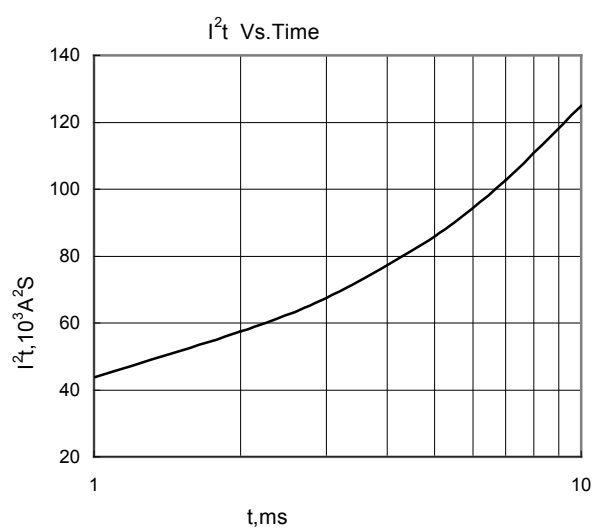
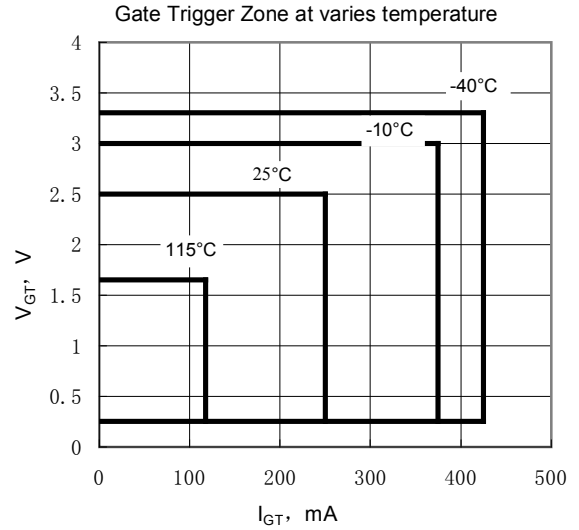
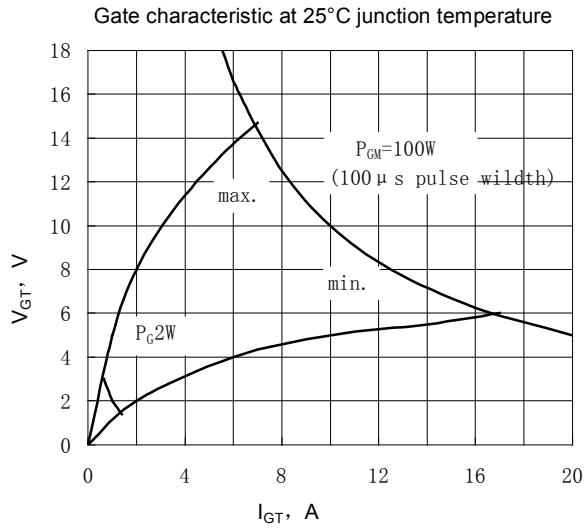
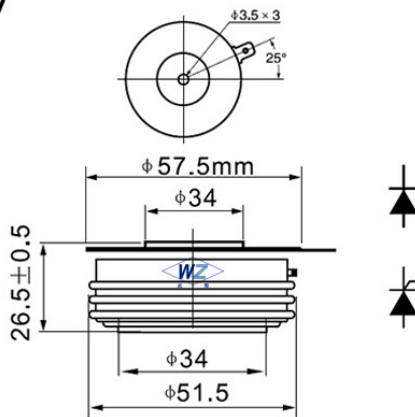

Fig.4



Dimensions:

C17



C4

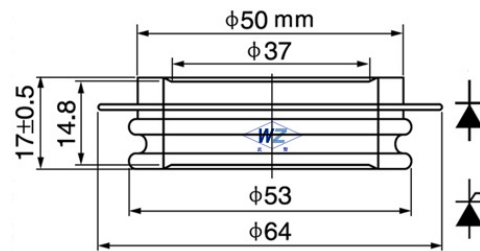

Wuhan Wuzheng Rectifier Co., Ltd

Add: NO. 73 Gaoxin Five Road, East Lake New Technology Development Zone, Wuhan City, Hubei province.

Tel : 86-27-87001995

Fax: 86-27-87180920

Email: info@techele.com

Web: www.techele.com/en

cn-techele.en.alibaba.com